

Installation must be installed by a qualified electrician (BS7671).
Read before installation and retain for future reference.
Always check for concealed pipes and cables before installation.
Suitable for use with a Triac Dimmer

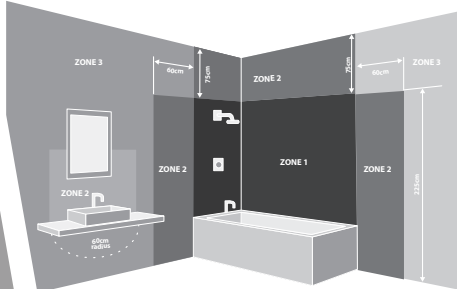

LOCATION

This product is suitable for zones 1 and 2 (not zone 0).

Zone 1: the area around the bathtub or shower basin up to a height of 2.25m above the floor and at a radius of 1.2m from the water outlet.

Zone 2: is limited by the vertical planes external to zone 1 and parallel vertical plane(s) 0.60m external to zone 1.

Ensure a minimum ceiling-void depth of 260mm is available.

Suitable for 30, 60, and 90 minute fire rated ceilings.

In a bathroom, product must be supplied via a 30mA residual current device (RCD).

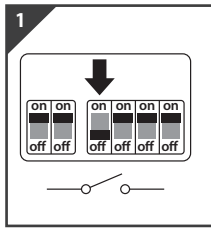
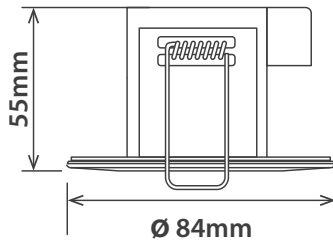

Switch OFF at mains supply before installing

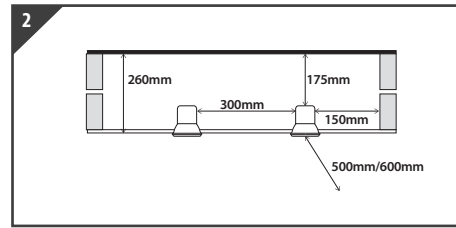

Ensure product is located in the correct location

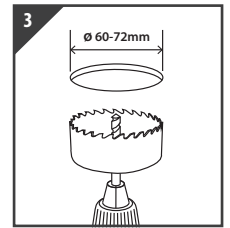

Carefully cut out hole in the mounting surface

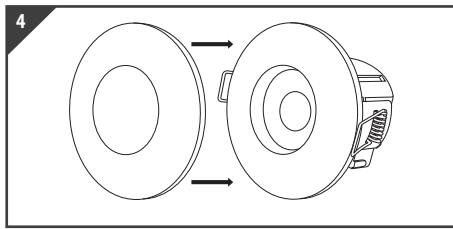

Clip on the decorative Chrome (S15345) or Brushed Chrome (S15346) bezel if required. Once in place the bezel can only be removed with the use of a screwdriver

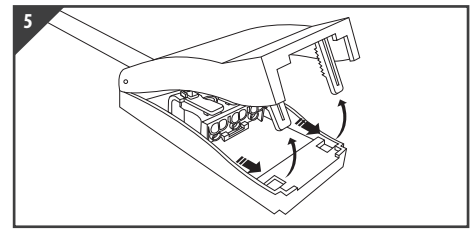

To open cover pull teeth away from downlight and lift

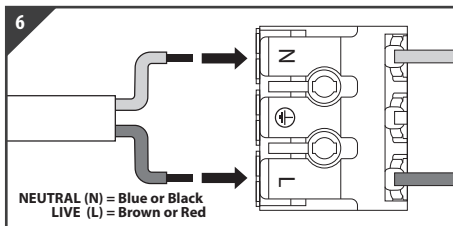

NEUTRAL (N) = Blue or Black
LIVE (L) = Brown or Red

Push down the terminal, insert correct supply (as above) into terminal block and release the push fit terminal to secure. Product is Class II. ⊕ terminal for Earth provision only

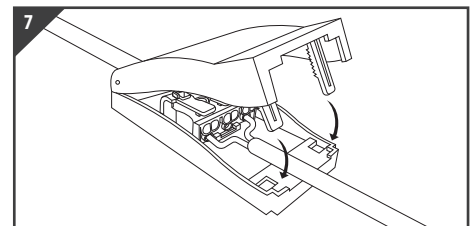

Close the cover to secure the mains cable in place

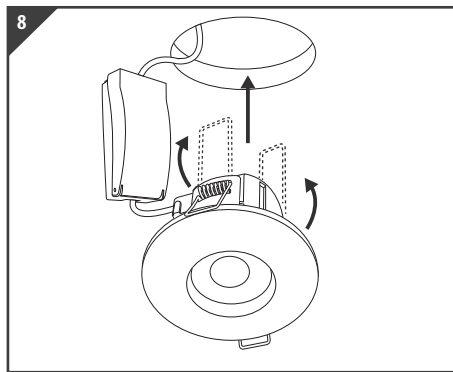

Push springs upwards against the body of the downlight and insert in the hole

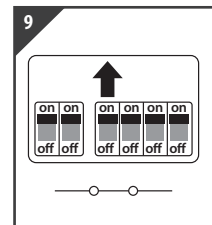

Return power. Switch ON at mains supply

240V~50/60Hz



DO NOT MODIFY – this will invalidate the warranty and could be dangerous.

Waste electrical products should not be disposed of with household waste. Please recycle where facilities exist. Check with your Local Authority or retailer for recycling advice.