

# Product Information

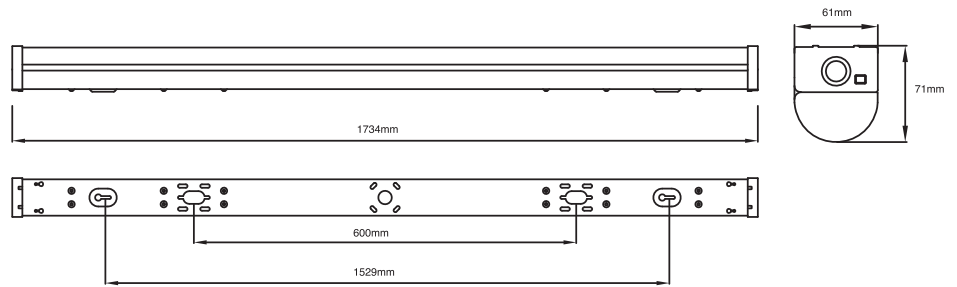

## Technical Specifications

| Model  | Voltage     | Power | Power Factor | Lumen (±5%) | Beam angle | CCT   | Lifespan | CRI | Dimmable | Dimension                            |
|--------|-------------|-------|--------------|-------------|------------|-------|----------|-----|----------|--------------------------------------|
| S15411 | AC 220-240V | 65W   | >0.9         | 8400        | 120°       | 4000K | 50000h   | >80 | No       | 1734*61*71mm, fixing distance 1529mm |

## Driver data Sheet

| Driver data              | DIM        |
|--------------------------|------------|
| Input rated Voltage      | AC220-240V |
| Frequency                | 50/60Hz    |
| Input Voltage            | AC180-264V |
| Efficiency               | 90%        |
| Total load Wattage       | 65W        |
| Power Factor             | >0.95      |
| Rated input current      | <0.45A     |
| Full load output Voltage | 28-40V     |
| Rated output current     | 1500mA     |
| Output current range     | 1500±5%    |
| Power tolerance          | ±5%        |
| Current output tolerance | ±5%        |
| Withstand voltage        | 2000V      |
| Short circuit protection | PASS       |
| Overload protection      | PASS       |
| No-load protection       | PASS       |

## Fixture Compatibility

| Rated Wattage | Electrical Classification | Ingress Protection | Operating Temp | Operating Humidity | Storage Temp |
|---------------|---------------------------|--------------------|----------------|--------------------|--------------|
| 65W           | I                         | IP20               | -20°C-45°C     | 10-90%             | -40°C-80°C   |

## Spectral Distribution

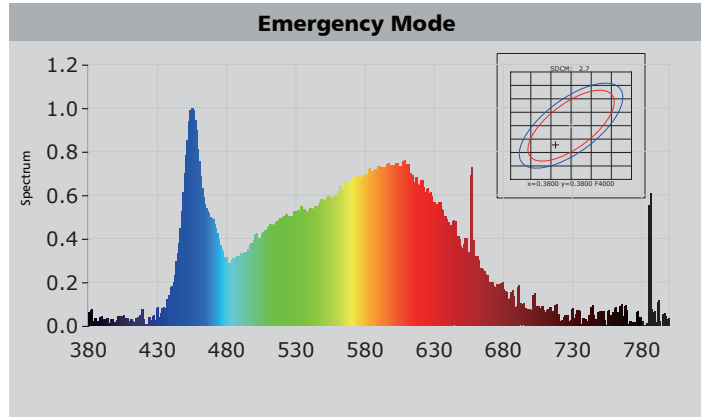
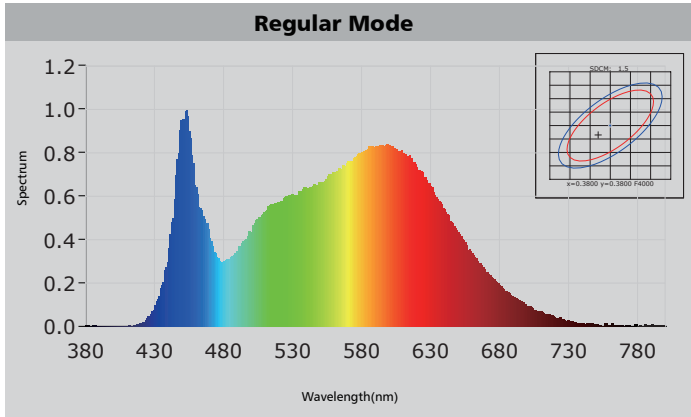

## Photometric Diagram

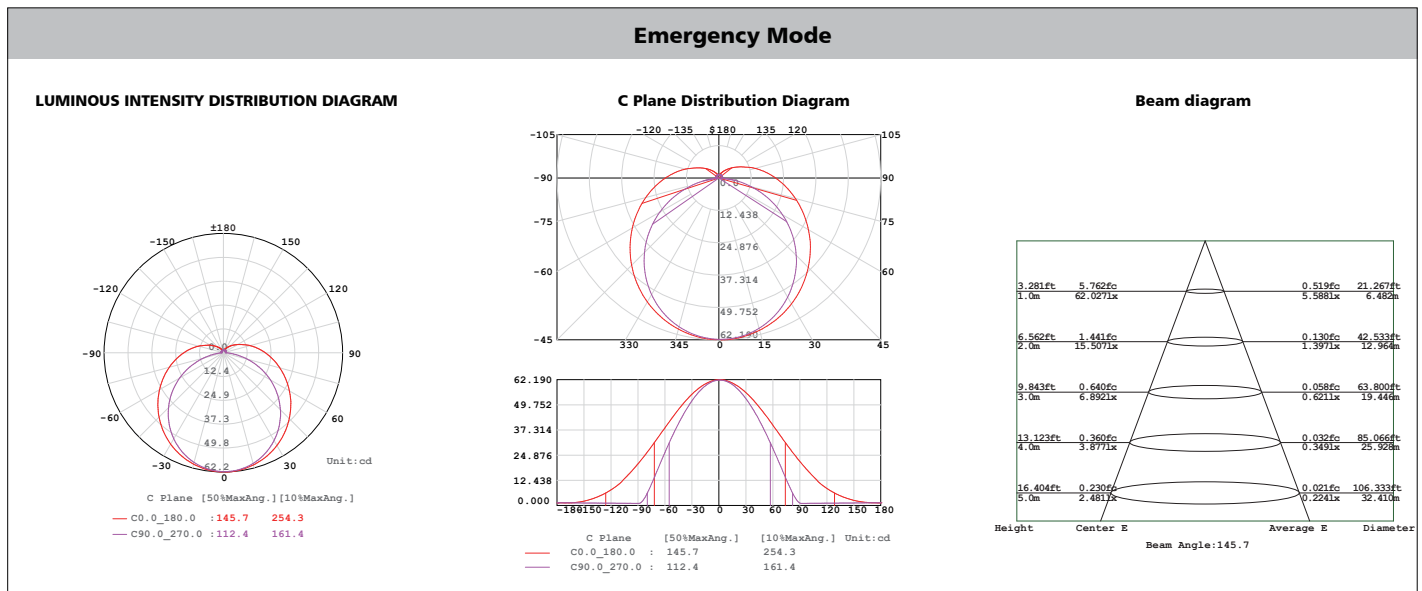
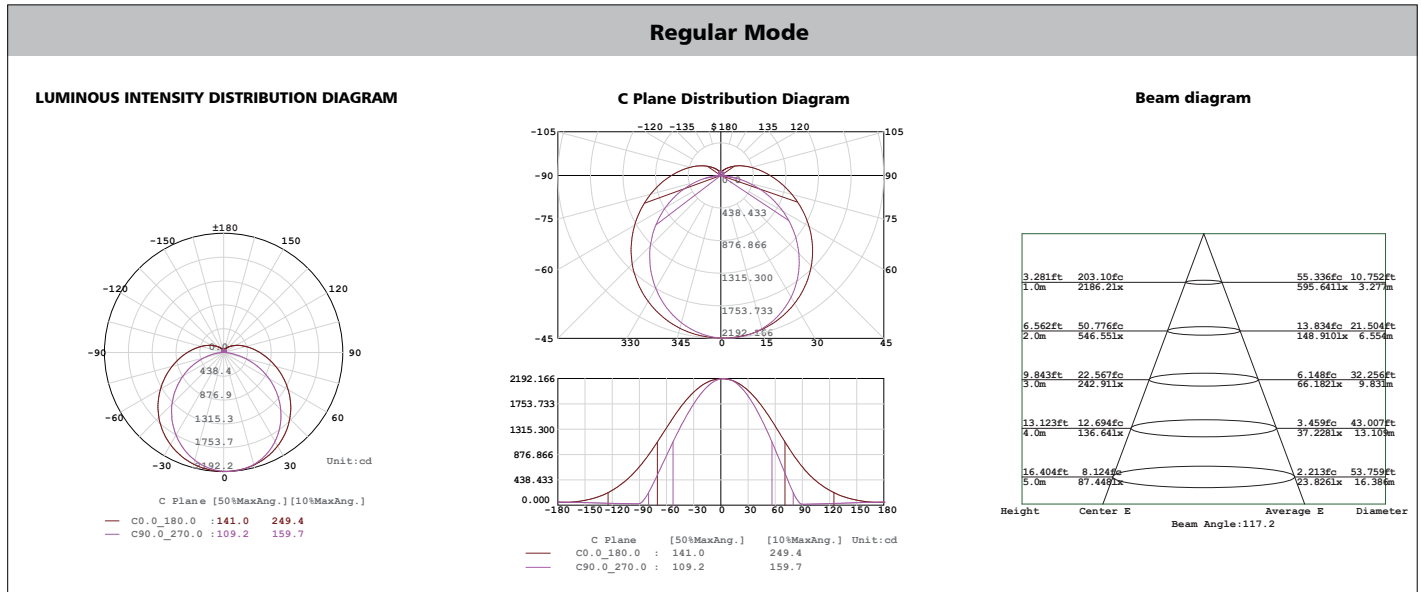

## Polar Diagram Comparison

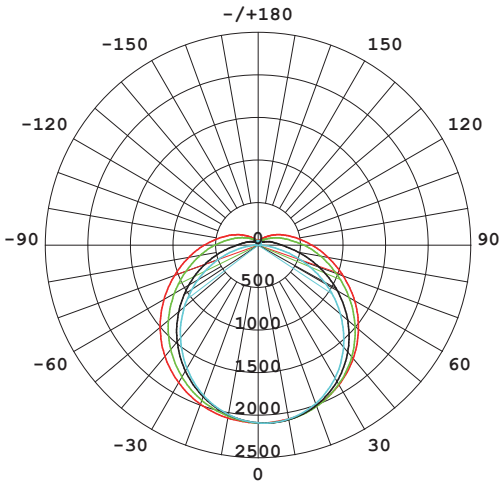

AVERAGE BEAM ANGLE (50%) : 124.6 DEG

## Average Lumen Maintenance and Chromaticity Shift VS. Time

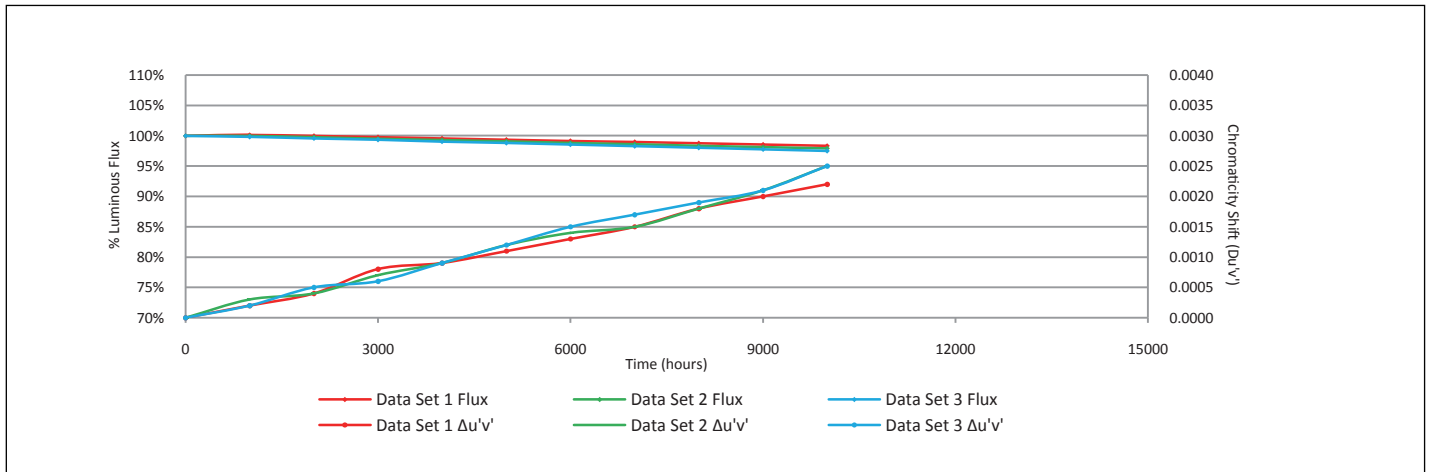

## Installation

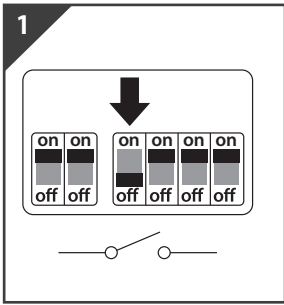

Switch OFF at mains supply before installing

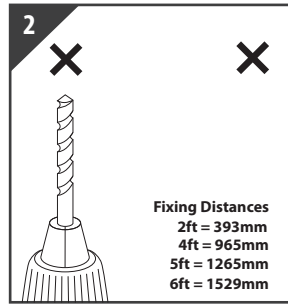

Drill holes to the required distance and install plugs

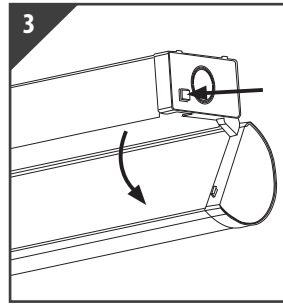

Push button on end-cap and pull open casing

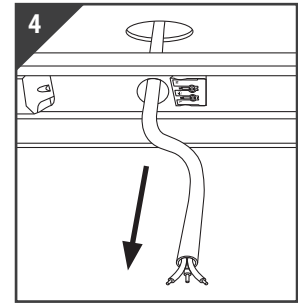

Pull cable from ceiling through hole in batten

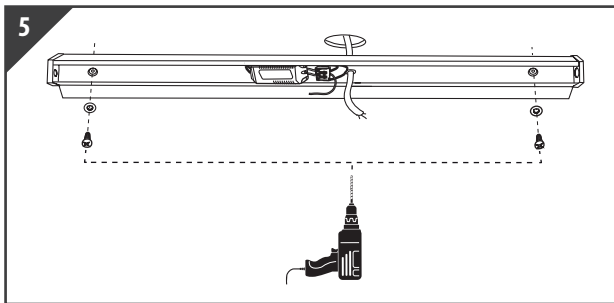

Drill screws into previously installed plugs

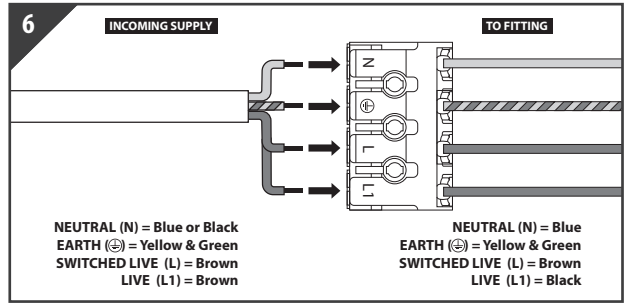

Push down the terminal, insert correct supply (as above) into terminal block, for the emergency unit to work correctly please ensure that an uninterrupted permanent live feed is present and is connected directly to the (L1) "Permanent Live" terminal of the connector block. Release the push fit terminal to secure.

Note: Please ensure there are no switches, PIRS etc in the permanent live feed, as switching of the emergency pack will reduce the battery's life considerably.

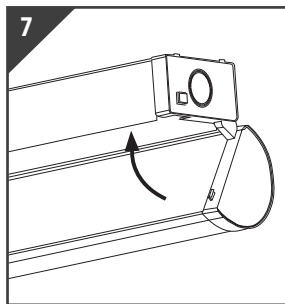

Close casing ensuring it clicks into place

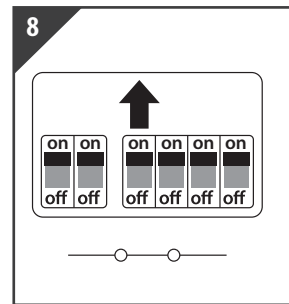

Return power. Switch ON at mains supply

## Packaging Information

|        | SIZE(CM)        | N.W/pc (KGS) | G.W.(KGS) | Q'TY(PCS) |
|--------|-----------------|--------------|-----------|-----------|
| Carton | 175.5*22.5*17.5 | 2.3          | 14        | 6         |

|                        | CTNS | Q'TY(PCS) | VOLUME(CBM) |
|------------------------|------|-----------|-------------|
| 20" standard container | 400  | 2400      | 27.64       |
| 40" standard container | 835  | 5010      | 57.7        |

