

Safety and Installation Instructions

Please read these instructions thoroughly before use and retain for future reference.

* The T8 LED lamp is made up of T8 LED tube and LED starter.





* The T8 LED lamp is used for replacing the T8 fluorescent lamps:

- T8-GL-600-8W - replaces T8 fluorescent lamp 18W
- T8-GL-1200-17W - replaces T8 fluorescent lamp 36W
- T8-GL-1500-22W - replaces T8 fluorescent lamp 58W
- T8-GL-1800-30W - replaces T8 fluorescent lamp 70W

* The T8 LED working temperature is -20°C to 40°C

This lamp may not be suitable for use in all applications where a traditional fluorescent lamp has been used. The temperature range of this more restricted. In cases of doubt regarding the suitability of the application the manufacturer of this lamp should be consulted.

*This lamp is designed for general lighting service (excluding for example explosive atmospheres).

	Lamp is suitable for use in luminaires with magnetic ballasts.		Lamp should be used in dry conditions or in a luminaire that provides protection.
	Lamp is not suitable to be used in emergency luminaires designed for double-capped fluorescent lamp(s).		Lamp is not dimmable.

Operating instructions of light replacement (Only used with Magnetic Ballasts)

Schematic steps of removing a fluorescent lamp and inserting a double-capped LED lamp designed to retrofit linear fluorescent lamp

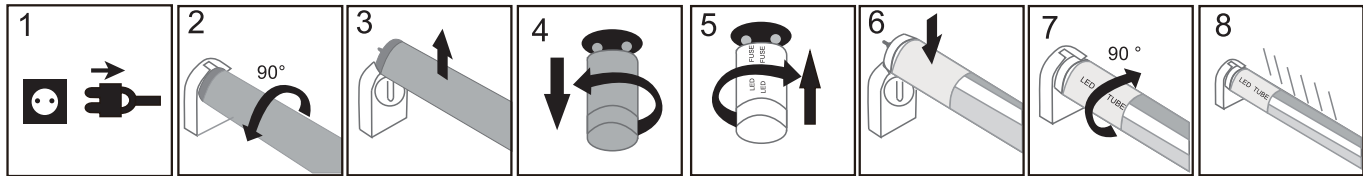

- 1) Switch off electricity.
- 2) and 3) Remove the conventional lamp.
- 4) Remove the starter.
- 5) Click the LED replacement starter into the starter holder.
- 6) Insert the LED lamp into the lampholder.
- 7) Secure the position by turning the lamp by 90°.
- 8) Switch on electricity and check for the lamp starting.

Operating Instructions: (Diagram)

1. Installation of light replacement (Magnetic Ballasts)

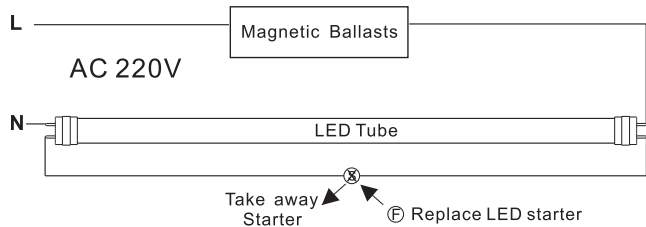

2. Installation of new light

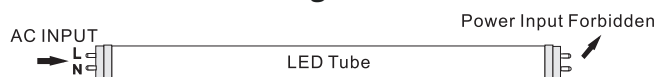

3. Installation of light replacement (Electronic Ballasts)

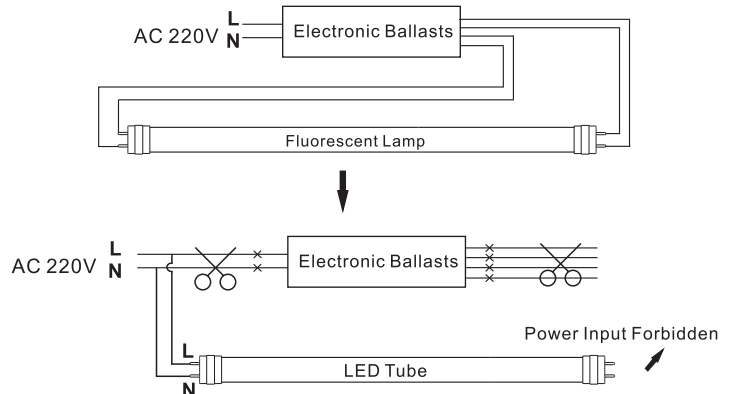

PS: Must be installed by a professional electrician