

Installation must be installed by a qualified electrician (BS7671).
Read before installation and retain for future reference.
Always check for concealed pipes and cables before installation.



LOCATION

This Product is suitable for Zone 3 only.
(Not Zones: 0, 1, or 2).

Zone 1: the area around the bathtub or shower basin up to a height of 2.25m above the floor and at a radius of 1.2m from the water outlet.

Zone 2: is limited by the vertical planes external to zone 1 and parallel vertical plane(s) 0.60m external to zone 1. Ensure a minimum ceiling-void depth of 260mm is available.

Suitable for 30, 60, and 90 minute fire rated ceilings.

In a bathroom, product must be supplied via a 30mA residual current device (RCD).

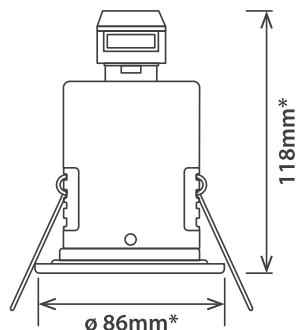

* Approximate measurement.

** Suitable only for use with an appropriately rated dimmer switch.
When using LED's ensure appropriate rated dimmer switch is used.

Light Source (not included):

- 1 x 50/40 Watt Halogen GU10
- 1 x LED GU10

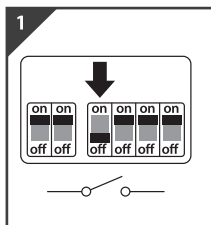

Switch OFF at mains supply before installing

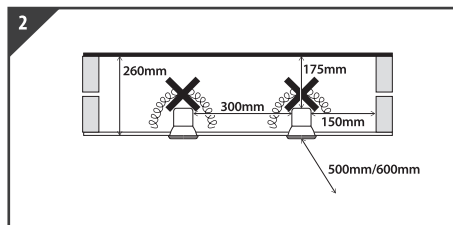

Ensure product is located in the correct location using the minimum spacings shown above. Under NO circumstances should these fittings be covered with insulation material or similar.

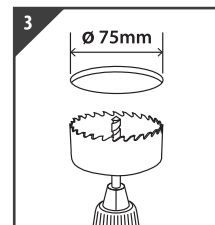

Carefully cut out hole

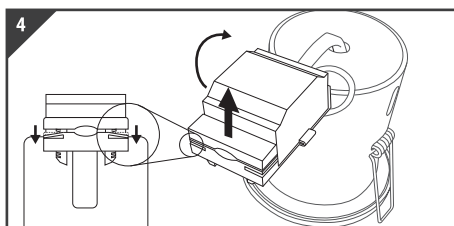

Use a small flat head screwdriver to release the terminal block cover. Press down tabs on either side to release the cable grip locking tabs and lift the cable grip.

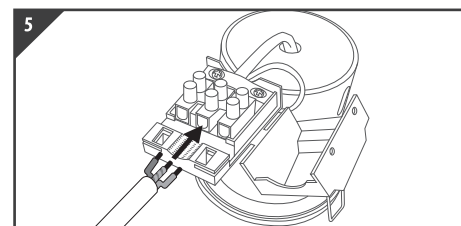

Insert correct supply (240 V/50Hz - H03VV-F 1.0mm2 core cable) into terminal block

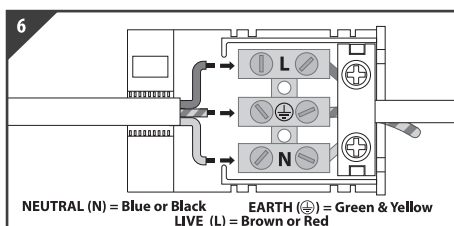

When the cable is correctly inserted into terminal block, tighten all screws in block. Product MUST be earthed

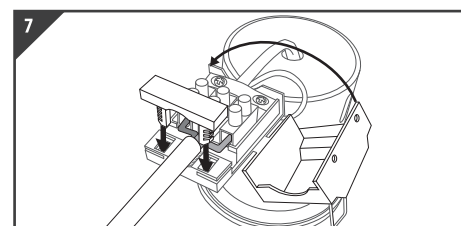

Push cable grip into position and close the terminal block cover

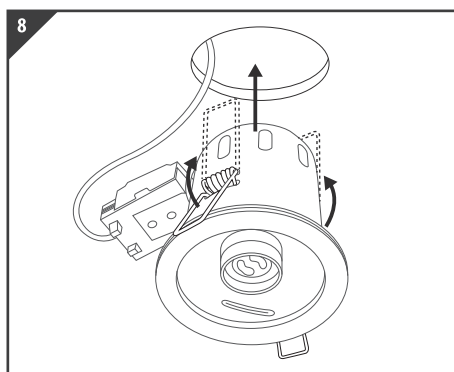

Push springs upwards against the body of the downlight and insert in the hole

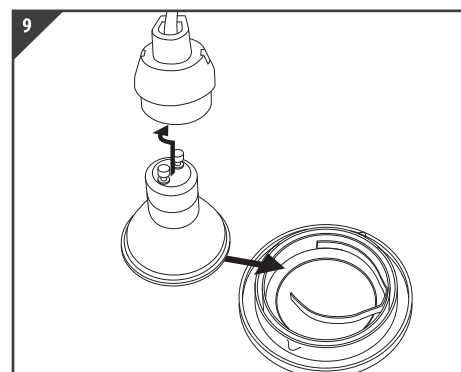

Insert correct wattage of GU10 lamp into the light socket. Slide connected GU10 into the lamp casing

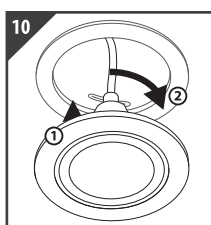

Push casing with correctly connected GU10 into the main housing. Casing will only insert when pins are aligned correct. Twist to lock into position.

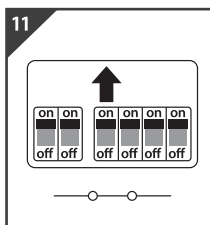

Return power. Switch ON at mains supply

DO NOT MODIFY – this will invalidate the warranty and could be dangerous.
Waste electrical products should not be disposed of with household waste. Please recycle where facilities exist. Check with your Local Authority or retailer for recycling advice.

This product is in accordance with building regulations Part E (resistance to the passage of sound).

